

T = Used for Teflon fitted pumps only

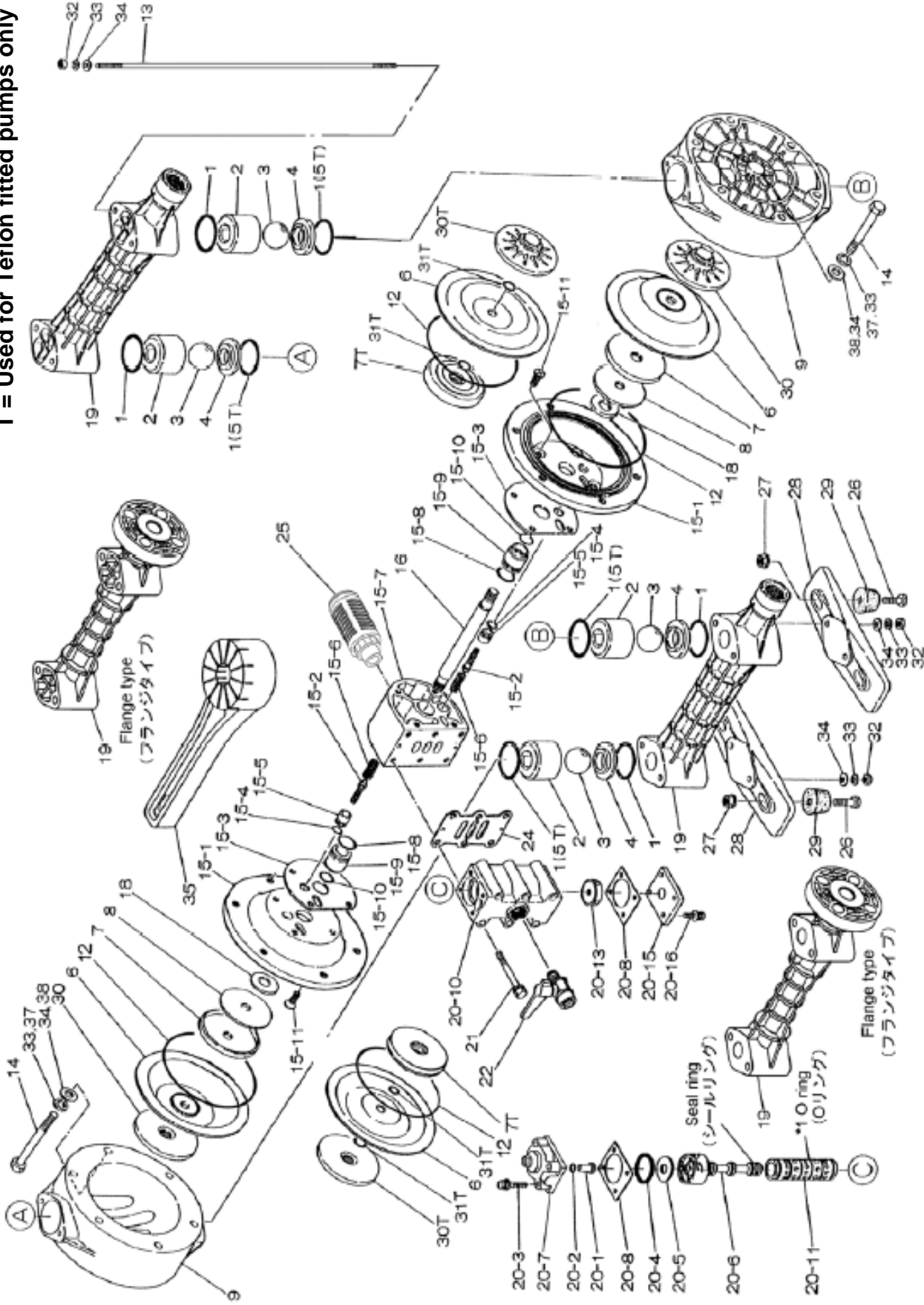

Model: NDP-25BVS  
Part # 852773

Yamada America, Inc.  
955 East Algonquin Rd  
Arlington Heights, IL 60005  
Phone: 847.631.9200  
Fax: 847.631.9273  
www.yamadapump.com

Reference			
No.	Description	Q'ty	
1	O-ring	4	643042
2	Valve Stopper	4	780141
3	Ball	4	770691
4	Valve Seat	4	780139
5	O-ring	4	643041
6	Diaphragm	2	771974
7	Center Disk	2	716258
8	Plain Washer	2	716259
9	Out Chamber	2	780136
12	O-ring	2	640154
13	Tie Rod	4	710207
14	Bolt	12	621189
15	Body Assembly*	1	803638
16	Center Rod	1	710271
18	Cushion	2	771054
19	Manifold - NPT	2	780057
19	Manifold - Flange	2	780212
20	Valve Body Assembly*	1	802809
21	Bolt	6	682265
22	Ball Valve	1	684320
24	Gasket	1	771056
25	Silencer	1	804697
26	Bolt	4	611153
27	Nut with Flange	4	682276
28	Pump Base	2	771749
29	Cushion	4	770551
30	Center Disk	2	780127
32	Nut	8	683635
33	Spring Lock Washer	8	681300
34	Plain Washer	8	631329
35	Accessory Tool	2	771244
37	Spring Lock Washer	12	680257
38	Plain Washer	12	631330

Repair Kits			
K25-VS Liquid Side Repair Kit			
No.	Description	Q'ty	
1	O-ring	8	643042
3	Ball	4	773131
5	O-ring	4	643041
6	Diaphragm	2	771974
K225-AM Air Side Repair Kit			
No.	Description	Q'ty	
18	Cushion	2	771054
24	Gasket	1	771056
15-2	Pilot Valve Assy.	2	802360
15-3	Gasket	2	771057
15-4	O-ring	2	640009
15-5	Valve Seat	2	771945
15-6	Spring	2	708666
15-8	O-ring	2	685276
15-9	Throat Bearing	2	772703
15-10	Packing	2	685414
20-2	O-ring	1	640005
20-4	Packing	1	771241
20-6-seal	Seal Ring	5	771053
20-8	Gasket	2	771240
20-11-*1	O-ring	6	771080
20-13	Cushion	1	771914

Body Assembly - 803638			
Reference			
No.	Description	Q'ty	
15-1	Air Chamber	2	715940
15-2	Pilot Valve Assembly	2	802360
15-3	Gasket	2	771057
15-4	O-ring	2	640009
15-5	Valve Seat	2	771945
15-6	Spring	2	708666
15-7	Body	1	711503
15-8	O-ring	2	685276
15-9	Throat Bearing	2	772703
15-10	Packing	2	685414
15-11	Flat Head Bolt	8	682486

Valve Body Assembly - 802809			
Reference			
No.	Description	Q'ty	
20-1	Reset Button	1	709161
20-2	O-ring	1	640005
20-3	Bolt	4	682704
20-4	Packing	1	771241
20-5	Plain Washer	1	710270
20-6	C Spool Valve Assy.	1	802400
20-6-seal	Seal Ring	5	771053
20-7	Cap	1	711219
20-8	Gasket	2	771240
20-10	Valve Body	1	711640
20-11	Sleeve Assembly	1	803931
20-11-*1	O-ring	6	771080
20-13	Cushion	1	771914
20-15	Cap	1	711212
20-16	Bolt	4	682262

Yamada America, Inc.  
955 East Algonquin Rd  
Arlington Heights, IL 60005  
Phone: 847.631.9200  
Fax: 847.631.9273  
www.yamadapump.com